

5

RESIDENTIAL UNIT
 TWO BEDROOM, THREE BATH
 1096 SF

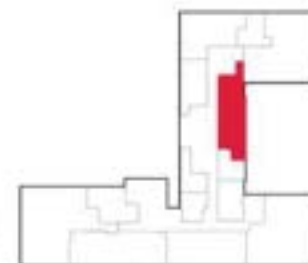

KEY PLAN : NOT TO SCALE

All designs and development plans are diagrammatic and are subject to change without notice. Room dimensions are approximate. Stated unit areas are measured to the approximate centers of interior walls and partitions and include all but the outer 6" of exterior walls; no deductions have been taken for shafts and chases within the unit boundary; refer to Plats and Plans for boundary detail.

March 27, 2006